

Work Instruction Number 109 - "Workforce in Road" signs (Relaxation Works)
 All Amberon Traffic Management Installations or Removals on any main road or
 approaching road works 40mph and above" (unless the site specific risk
 assessment deems it necessary on lower speeds of 40mph) must display the
 "Workforce in road Slow" sign, this being the 1st Sign out and last sign in.

**WORKFORCE
 IN ROAD
 SLOW**

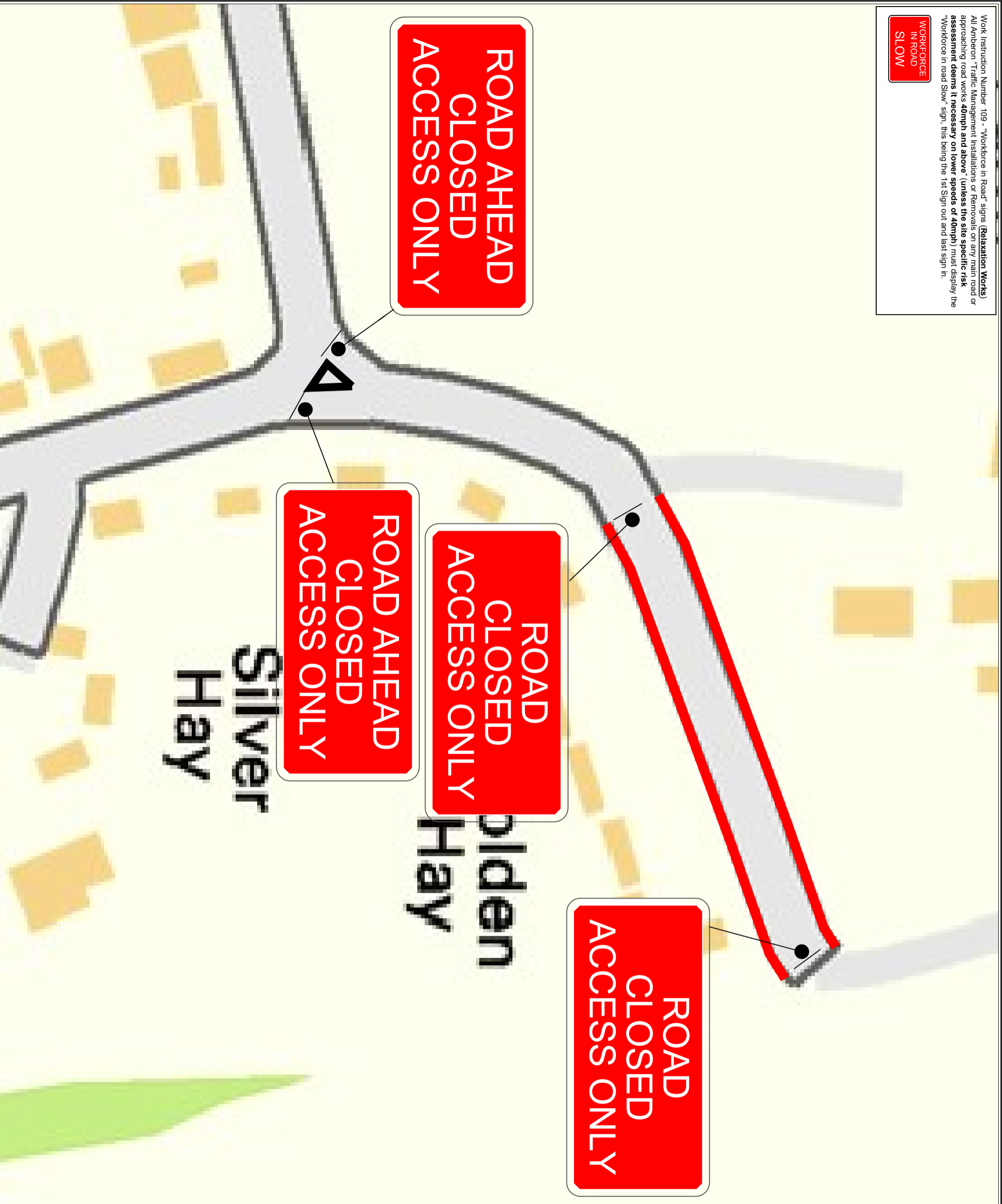

Notes

THIS DRAWING MAY BE USED ONLY FOR THE PURPOSE INTENDED AND ONLY WRITTEN DIMENSIONS SHALL BE USED

1. All dimensions in metres.
2. Sign locations indicative only, exact sign locations to be determined on site.
3. Refer to Chapter 8 TSM for key to detail.
4. All works Access & Exits to be Agreed on Site.
5. Refer to Safety at StreetWorks and Road Works for Key to detail.
- 6 All TM will be installed in Accordance with Chapter 8 of the Traffic signs Manual
7. Workforce In Road SLOW to be risk assessed in advance of the Initial man at work sign
8. Tapers will be installed in conjunction with IAN 163/12
9. Advance Signage Shall be installed in Conjunction with IAN 153/16

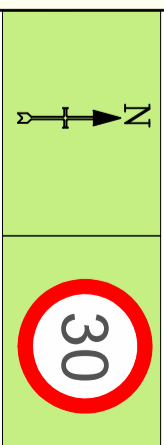

Customer Name
AVONLINE

Project Name:
**The Mill House, Bank Farm
 Barns, Dumbleton, Evesham
 WR11 7TJ**

Drawing Title
Road Closure

Requested:	C. Johnson	22.06.22
Drawn:	P. Wilkinson	22.06.22
Approved:	D. Talbot	23.06.22
Revision:	Approved By:	Date:

Details:

Revision:	Approved By:	Date:
Revision:	Approved By:	Date:

Details:

Original Drawing Size:	NTS
Scale:	To Scale
Dimensions:	DIMS
Drawing No	PW/22.06.22.E84235